

Short cone ball lock zero locator and accessories

Reduce manual labor, improve efficiency, increase production capacity, and accelerate the intelligent upgrade of production and manufacturing

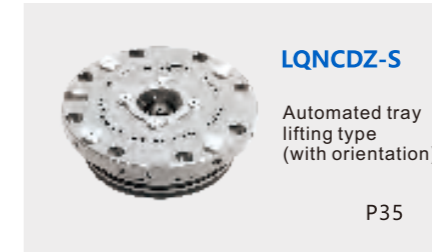

Short cone ball lock zero locator series

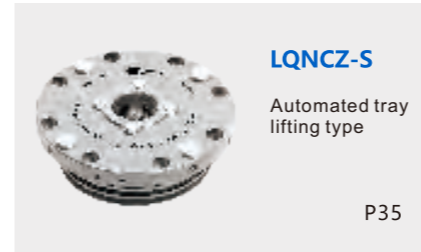

Short cone ball lock zero locator accessory

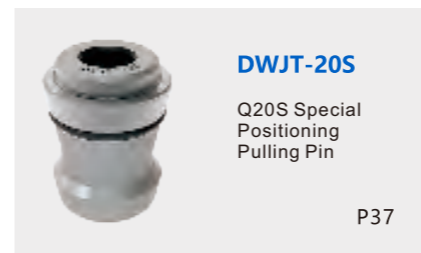



Automated pneumatic tray lifting type

Product features:

- Air pressure unlocking, spring mechanical locking;
- Material: Hardened stainless steel;
- Repetitive positioning accuracy<0.003mm;
- Equipped with lifting function, double-sided restraint, high precision, and strong rigidity;
- Includes surface blowing and cleaning function;
- Equipped with an airtight positioning and relaxation detection interface.

Applicable industry:

- Suitable for flexible production lines;
- Suitable for automated tray exchange.

Outline dimensions:

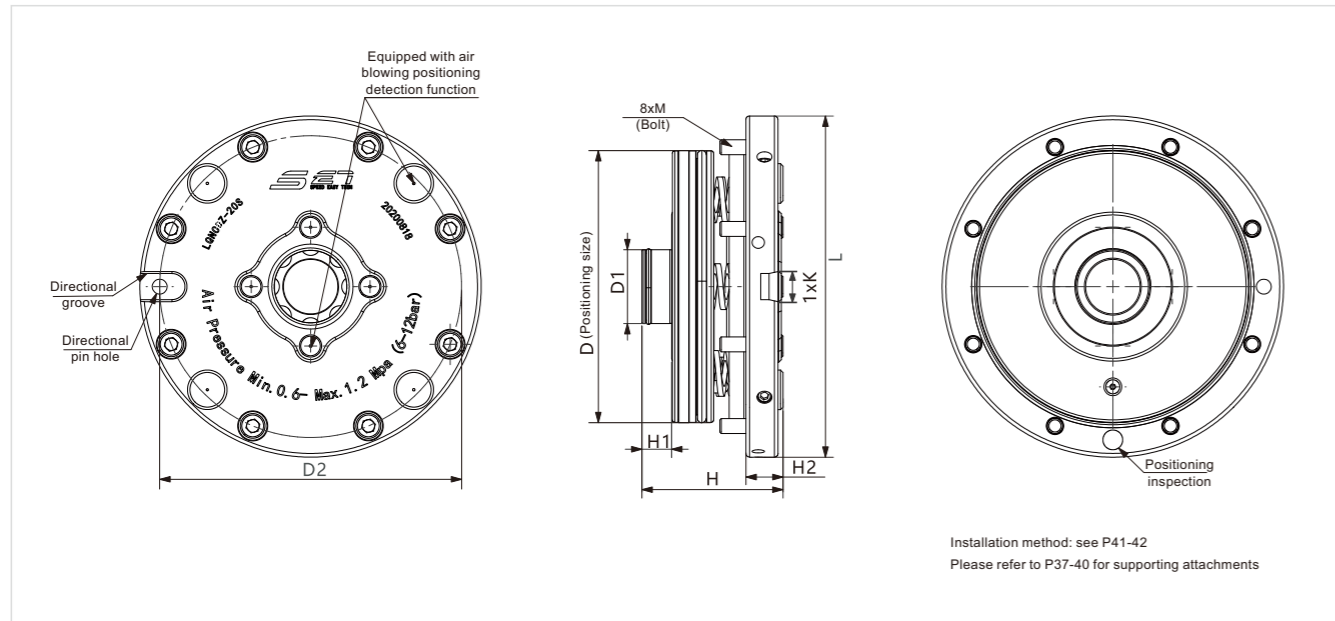

Main parameter table:

Order Number	Unlocking method	Clamping force (kN)	Tension force (kN)	Blow air	Lifting force (kg) (at 0.6MPa)	Weight (kg)
LQNCZ-10S	Gas pressure	10	25	√	50	1.7
LQNCZ-20S	Gas pressure	17	55	√	100	2.5
LQNCZ-40S	Gas pressure	40	105	√	150	4.2
LQNCZ-10S	Gas pressure	10	25	√	50	1.7
LQNCZ-20S	Gas pressure	17	55	√	100	2.5
LQNCZ-40S	Gas pressure	40	105	√	150	4.2

√ Capable of blowing air

Main parameter table:

Order Number	ØL	ØD (h6)	ØD1	ØD2	H	H1	H2	M	K
LQNCZ-10S	112	85	26	97	49	11	12	M6	/
LQNCZ-20S	138	110	30	122	57	12	15	M6	/
LQNCZ-40S	172	135	42	152	70	15	18	M8	/
LQNCZ-10S	112	85	26	97	49	11	12	M6	8
LQNCZ-20S	138	110	30	122	57	12	15	M6	10
LQNCZ-40S	172	135	42	152	70	15	18	M8	10

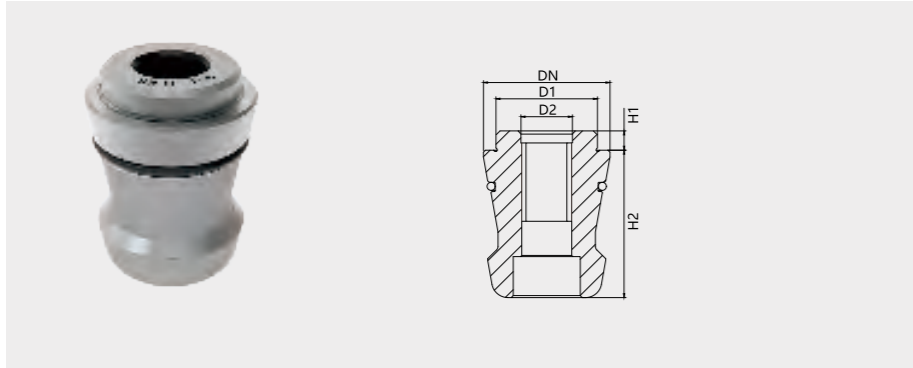

Positioning zipper (Q20S specific)

Product features:

- High precision requirements, surface hardening treatment;
- Plays a role in restricting free rotation in the X/Y direction during use;
- Suitable for short cone ball lock Q20S zero point locator

Main parameter table:

Order Number	Ø DN	Ø D1	Ø D2	H2	H1	Weight (g)
DWJT-20S	32	25	M12 (through)	36.7	5	140

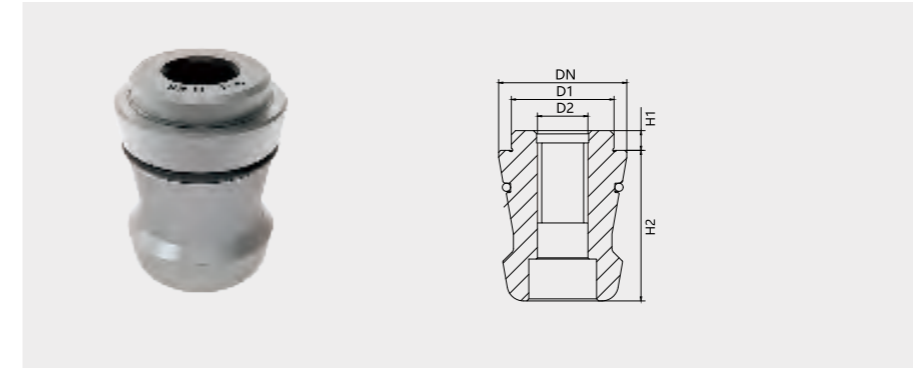

Locking Pulling Pin (Q20S Special)

Product features:

- Surface hardening treatment plays a role in increasing tension force;
- Ensure that the positioning tray is fully positioned to avoid over positioning;
- Suitable for short cone ball lock Q20S zero point locator.

Main parameter table:

Order Number	Ø DN	Ø D1	Ø D2	H1	H2	Weight (g)
SJIT-20S	31.8	25	M12 (through)	5	36.7	140

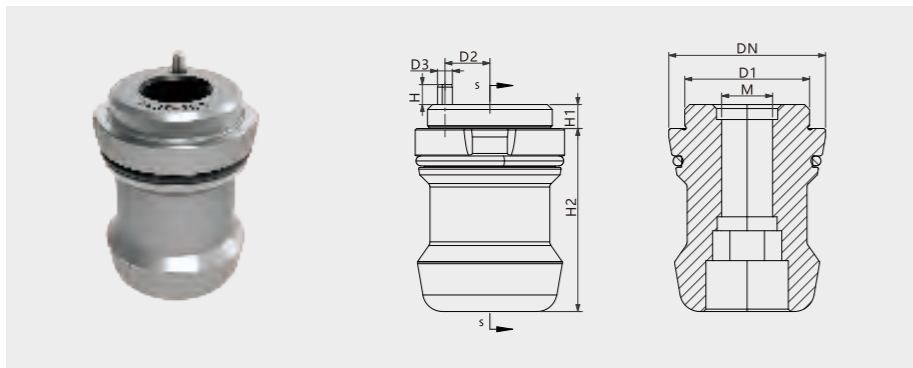

Directional pull nail (Q20S special)

Product features:

- Surface hardening treatment;
- Only restricting rotational freedom, serving as a directional function;
- Suitable for short cone ball lock Q20S zero point locator

Main parameter table:

Order Number	Ø DN	Ø D1 (h6)	D2	Ø D3	H	H1	H2	M	Weight (g)
DXJT-20S	32	25	9	3	4	5	36.7	M12 (through)	140

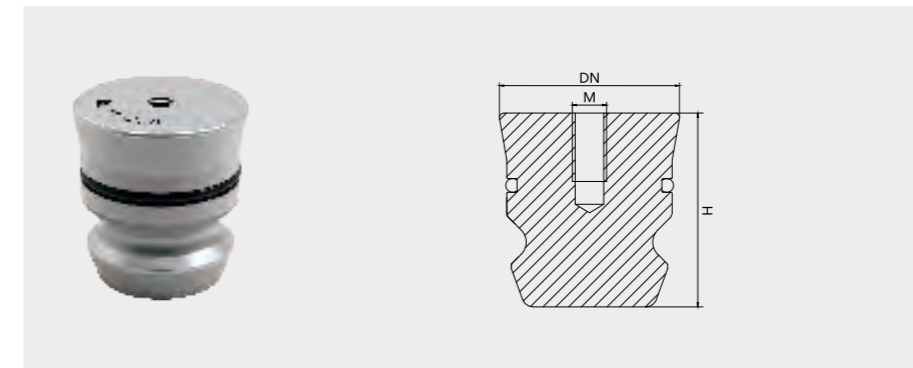

Protective plug (Q20S specific)

Product features:

- Material: Aluminum;
- Prevent debris from entering the interior of the zero point locator when it is not in operation;
- Suitable for short cone ball lock Q20S zero point locator.

Main parameter table:

Order Number	Ø DN	M	H	Weight(g)
BHJT-20S	31.8	6	34	20

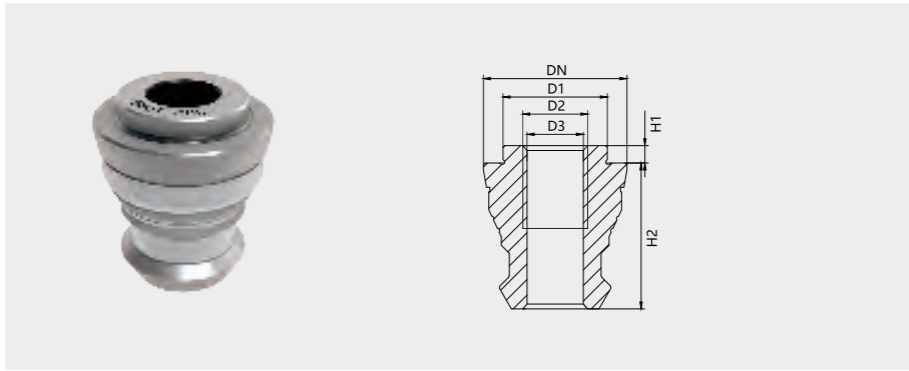

Positioning zipper (Q10S/Q40S specific)

Product features:

- High precision requirements, surface hardening treatment;
- Plays a role in restricting free rotation in the X/Y direction during use;
- Suitable for short cone ball lock Q10S/Q40S zero point locator.

Main parameter table:

Order Number	Ø DN	Ø D1	Ø D2	Ø D3	H1	H2	Weight (g)
DWJT-10S	28	20	M12 ↓ 17	10.3	5	30.5	80
DWJT-40S	42	30	M20 ↓ 20.5	16.5	5	42	240

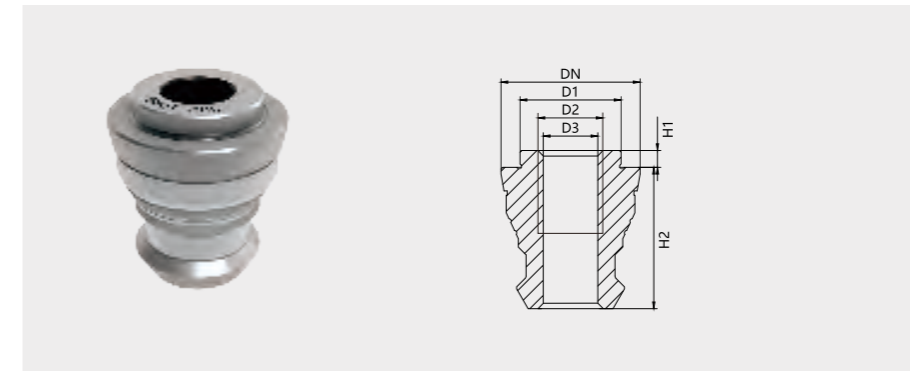

Locking Pulling Pin (Q10S/Q40S Special)

Product features:

- Surface hardening treatment plays a role in increasing tension force;
- Ensure that the positioning tray is fully positioned to avoid over positioning;
- Suitable for short cone ball lock Q10S/Q40S zero point locator.

Main parameter table:

Order Number	Ø DN	Ø D1	Ø D2	Ø D3	H1	H2	Weight (g)
SJJT-10S	27.6	20	M12 ↓ 17	10.3	5	30.5	80
SJJT-40S	41.6	30	M20 ↓ 20.5	16.5	5	42	240

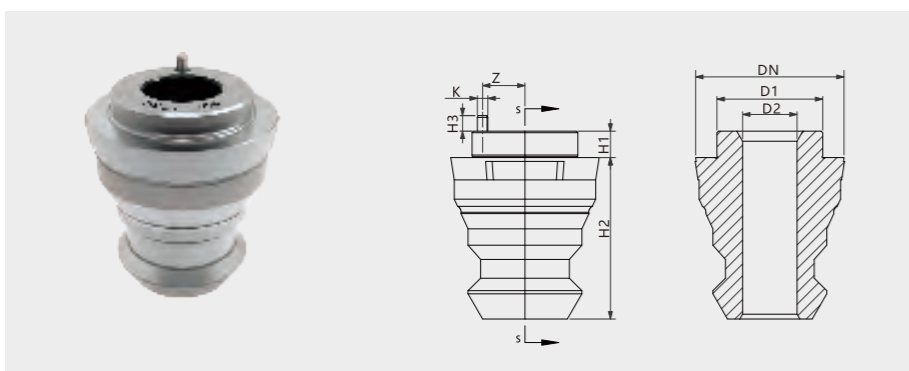

Directional pull nail (Q10S/Q40S special)

Product features:

- Surface hardening treatment;
- Only restricting rotational freedom, serving as a directional function;
- Suitable for short cone ball lock Q10S/Q40S zero point locator

Main parameter table:

Order Number	Ø DN	Ø D1 (h6)	D2	H2	H1	H3	ØK	Z	Weight (g)
DXJT-10S	28	20	M12 ↓ 17	30.5	5	3	2	8	80
DXJT-40S	42	30	M20 ↓ 20.5	42	5	4	3	12.5	240

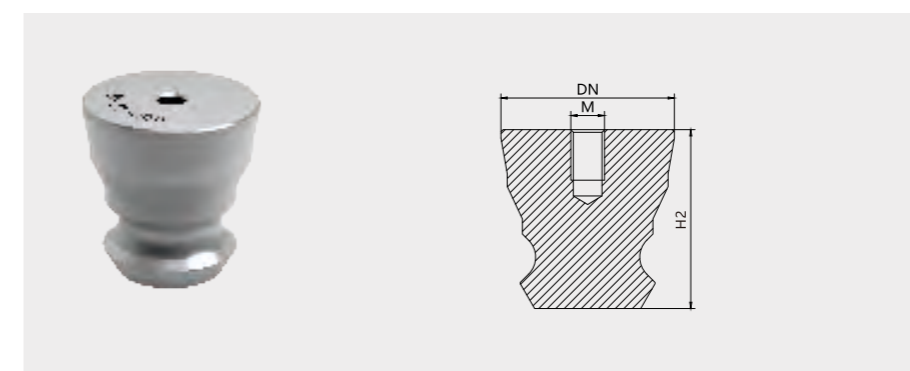

Protective plug (Q10S/Q40S specific)

Product features:

- Material: Aluminum;
- Prevent debris from entering the interior of the zero point locator when it is not in operation;
- Suitable for short cone ball lock Q10S/Q40S zero point locator.

Main parameter table:

Order Number	Ø DN	M	H2	Weight (g)
BHJT-10S	28	M6	31	31
BHJT-40S	42	M8	42.5	100

Short cone ball lock Q20S pull nail installation size:

Short cone ball lock Q20S bolt locking installation method:

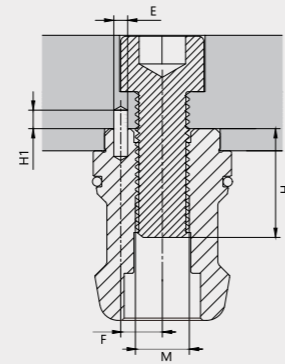
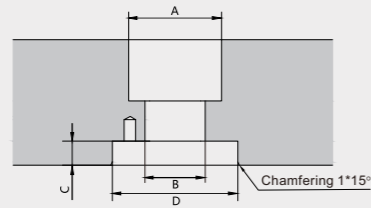

Order Number	Ø A	Ø B	C (0/+0.1mm)	Ø D (0/+0.01mm)	Ø E	F	M	H (max)	H1
DWJT-20S	20	12.5	5.2	25	/	/	M12	20	6
DXJT-20S	20	12.5	5.2	25	3.2	9	M12	20	6
SJT-20S	20	12.5	5.2	25	/	/	M12	20	6

Short cone ball lock Q20S bolt lower lock installation method:

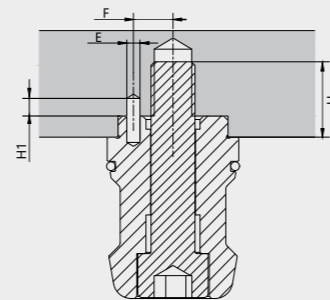
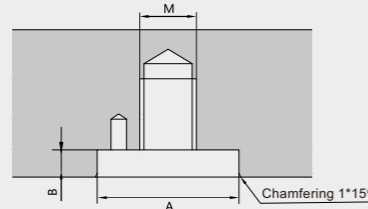

Order Number	Ø A (0/+0.01mm)	B (0/+0.1mm)	Ø E	F	H (min)	H1	M
DWJT-20S	25	5.2	/	/	19	6	M10
DXJT-20S	25	5.2	3.2	9	19	6	M10
SJT-20S	25	5.2	/	/	19	6	M10

Short cone ball lock Q10S/Q40S pull nail installation size:

Short cone ball lock Q10S/Q40S bolt locking installation method:

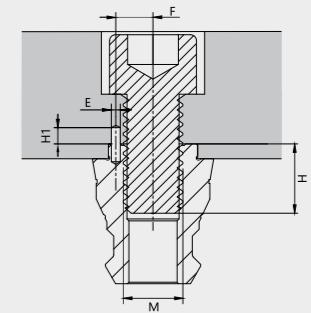
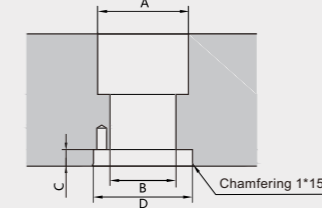

Order Number	Ø A	Ø B	C (0/+0.1mm)	Ø D	Ø E	F	M	H (max)	H1
DWJT-10S	20	12.5	5.2	20	/	/	M12	16	/
DXJT-10S	20	12.5	5.2	20	2.2	8	M12	16	4
SJT-10S	20	12.5	5.2	20	/	/	M12	16	/
DWJT-40S	34	21	5.2	30	/	/	M20	20	/
DXJT-40S	34	21	5.2	30	3.2	12.5	M20	20	6
SJT-40S	34	21	5.2	30	/	/	M20	20	/

Short cone ball lock Q10S/Q40S bolt lower lock installation method:

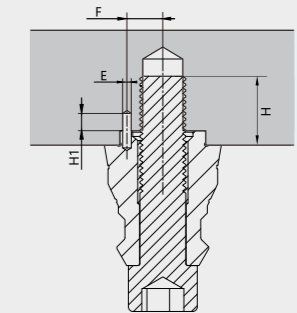
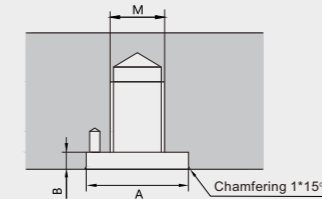

Order Number	Ø A	B (0/+0.1mm)	Ø E	F	H (min)	H1	M
DWJT-10S	20	5.2	/	/	20	/	M10
DXJT-10S	20	5.2	2.2	8	20	4	M10
SJT-10S	20	5.2	/	/	20	/	M10
DWJT-40S	30	5.2	/	/	30	/	M16
DXJT-40S	30	5.2	3.2	12.5	30	6	M16
SJT-40S	30	5.2	/	/	30	/	M16